

# FIL 01

## CONCRETE DECK NEGATIVE SLOPE REPAIR/FILL (SF)

SCALE: 3" = 1'-0"

### ROOF METAL DECK:

- STEEL DECK SHALL CONFORM TO THE CURRENT SPECIFICATIONS FOR THE DESIGN OF LIGHT GAGE COLD FORMED STEEL STRUCTURAL MEMBERS AS PER THE AISC LATEST EDITION OF STEEL DECK AND STANDARDS.
- DEPTH AND GAUGE OF ROOF METAL DECK SHALL MATCH EXISTING IN PROFILE. CONTRACTOR SHALL VERIFY THE PROFILE OF EXISTING ROOF DECK IN FIELD PRIOR TO ORDERING.
- DECK SHALL BE A MINIMUM OF THREE SPANS (OVER FOUR SUPPORTS) WHEREVER POSSIBLE.
- CONTRACTOR SHALL PROVIDE SHORING FOR METAL DECK WHERE DECK SPANS AND CONSTRUCTION LOADS EXCEED THE VALUES RECOMMENDED BY THE MANUFACTURER.
- CONTRACTOR SHALL PROVIDE HEADER MEMBERS FOR METAL DECK AT OPENINGS, IF REQUIRED.
- ALL METAL DECK IS TO BE GALVANIZED GRADE G90 PER ASTM A653, UNLESS OTHERWISE NOTED.
- ALL METAL DECK UNITS SHALL BE FASTENED TO THE SUPPORTING FRAMEWORK BY WELDING, IN ACCORDANCE WITH THE MANUFACTURER'S REQUIREMENTS. MINIMUM WELDS TO SUPPORT SHALL BE 5/8" DIAMETER PUDDLE WELDS AT EACH SUPPORT, SUCH THAT AVERAGE WELD SPACING DOES NOT EXCEED 12" ON CENTERS. SIDE LAPS ARE TO BE WELDED AT A MAXIMUM SPACING OF 18" ON CENTER.

### STEEL AND WELDING:

- THE DESIGN, MATERIAL, FABRICATION AND ERECTION OF ALL STRUCTURAL STEEL SHALL BE IN ACCORDANCE WITH THE NEW YORK CITY BUILDING CODE AS AMENDED AND AISC 335-89S1 "SPECIFICATION FOR STRUCTURAL STEEL BUILDINGS - ALLOWABLE STRESS DESIGN AND PLASTIC DESIGN, INCLUDING SUPPLEMENT NO.1, 2001."
- ALL WELDING SHALL BE PERFORMED IN ACCORDANCE WITH AWS SPECIFICATIONS, LATEST EDITION, AND SHALL CONFORM TO SECTION BC 2204.1 OF THE NEW YORK CITY BUILDING CODE.
- ALL WELDING SHALL BE PERFORMED BY CERTIFIED WELDERS WHO ARE LICENSED BY CITY OF NEW YORK IN ACCORDANCE WITH ARTICLE 407 OF THE NEW YORK CITY GENERAL ADMINISTRATIVE PROVISIONS.

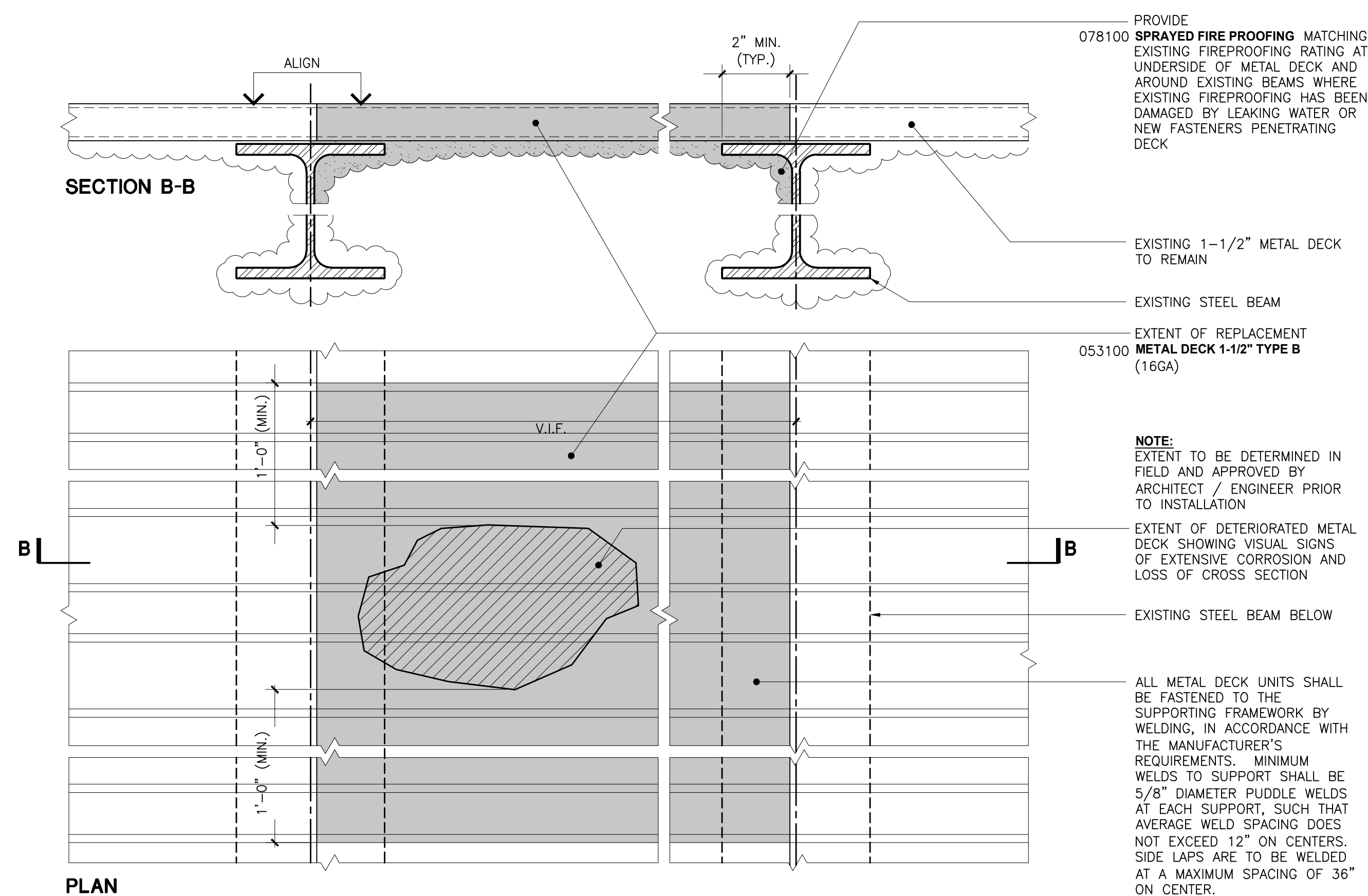

# DCK 01

## METAL DECK REPAIR (SF)

SCALE: 3" = 1'-0"

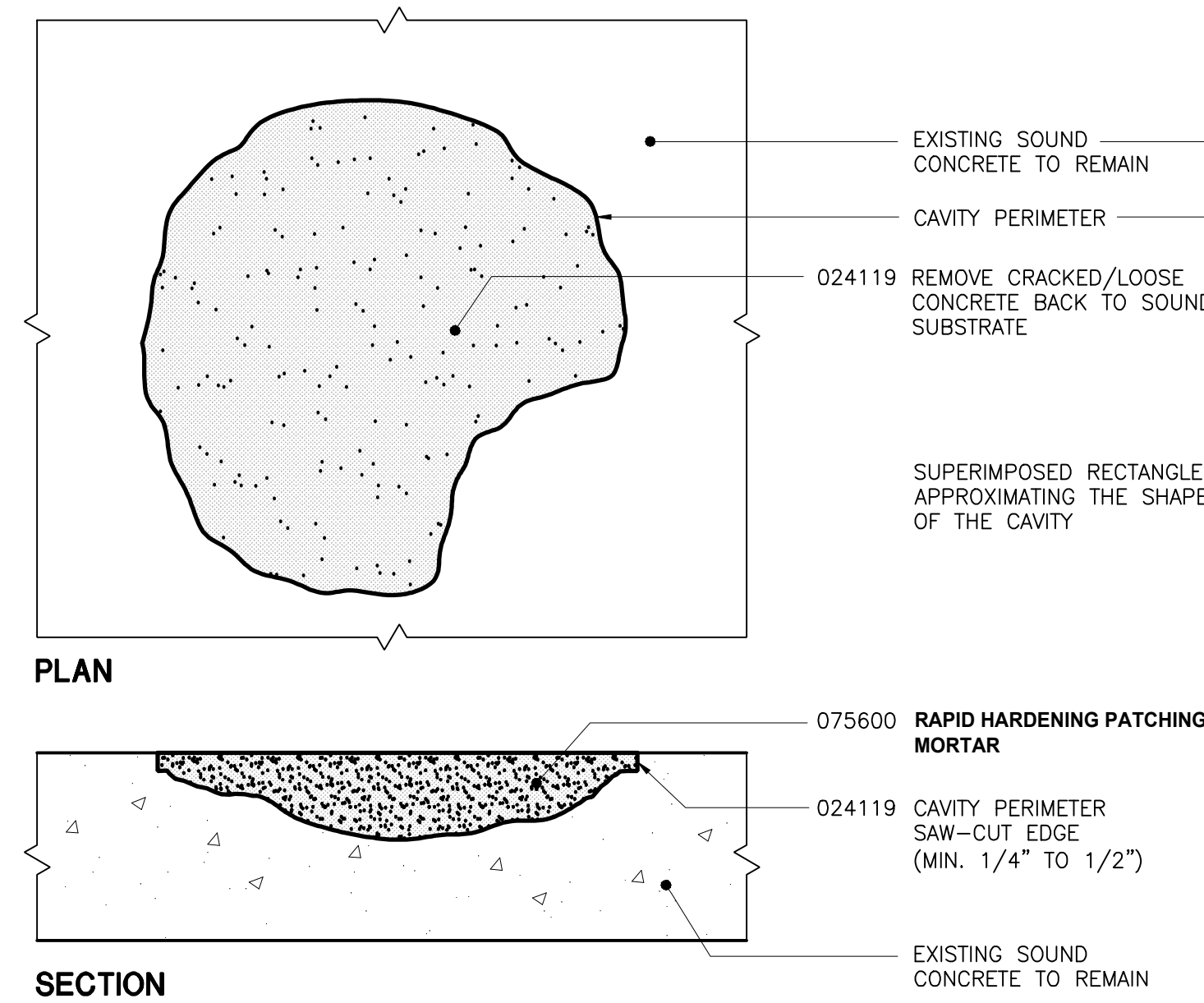

# CON 01

## CONCRETE DECK REPAIR/FILL (SF)

SCALE: 3" = 1'-0"

### REPAIR OF DETERIORATED CONCRETE

- AFTER REMOVING ROOFING SYSTEM, VISUALLY SURVEY CONCRETE.
- SOUND SURFACES WITH 3LB. DEAD BLOW HAMMER TO IDENTIFY EXTENT OF DETERIORATED/DELAMINATED CONCRETE TO BE REMOVED.
- MARK AREA OF DETERIORATED/DELAMINATED CONCRETE.
- CREATE A CAVITY BY REMOVING ALL LOOSE MATERIAL. (TAKE PHOTO & DOCUMENT LOCATION OF DETERIORATED AREAS BEFORE REPAIRING).
- DETERMINE QUANTITY OF CONCRETE REPAIR IN ACCORDANCE WITH QUANTIFICATION PROCEDURE DIAGRAM.
- PREPARE CAVITY SURFACE AND APPLY RAPID HARDENING PATCHING MORTAR AS RECOMMENDED BY MANUFACTURER'S INSTRUCTIONS.

### QUANTIFICATION PROCEDURE

- AT EACH CAVITY LOCATION, THE QUANTITY OF CONCRETE REPAIR EQUALS THE SUM OF THE AREAS OF THE SUPERIMPOSED RECTANGLES THAT APPROXIMATE THE SHAPE OF THE CAVITY.
- THE UNIT OF MEASURE FOR THE QUANTIFICATION OF CONCRETE REPAIR IS THE SQUARE FEET (SQ FT).
- THE QUANTITY OF CONCRETE REPAIR IN SQUARE FEET IS EQUAL TO:  $(A \times B) + (C \times D)$

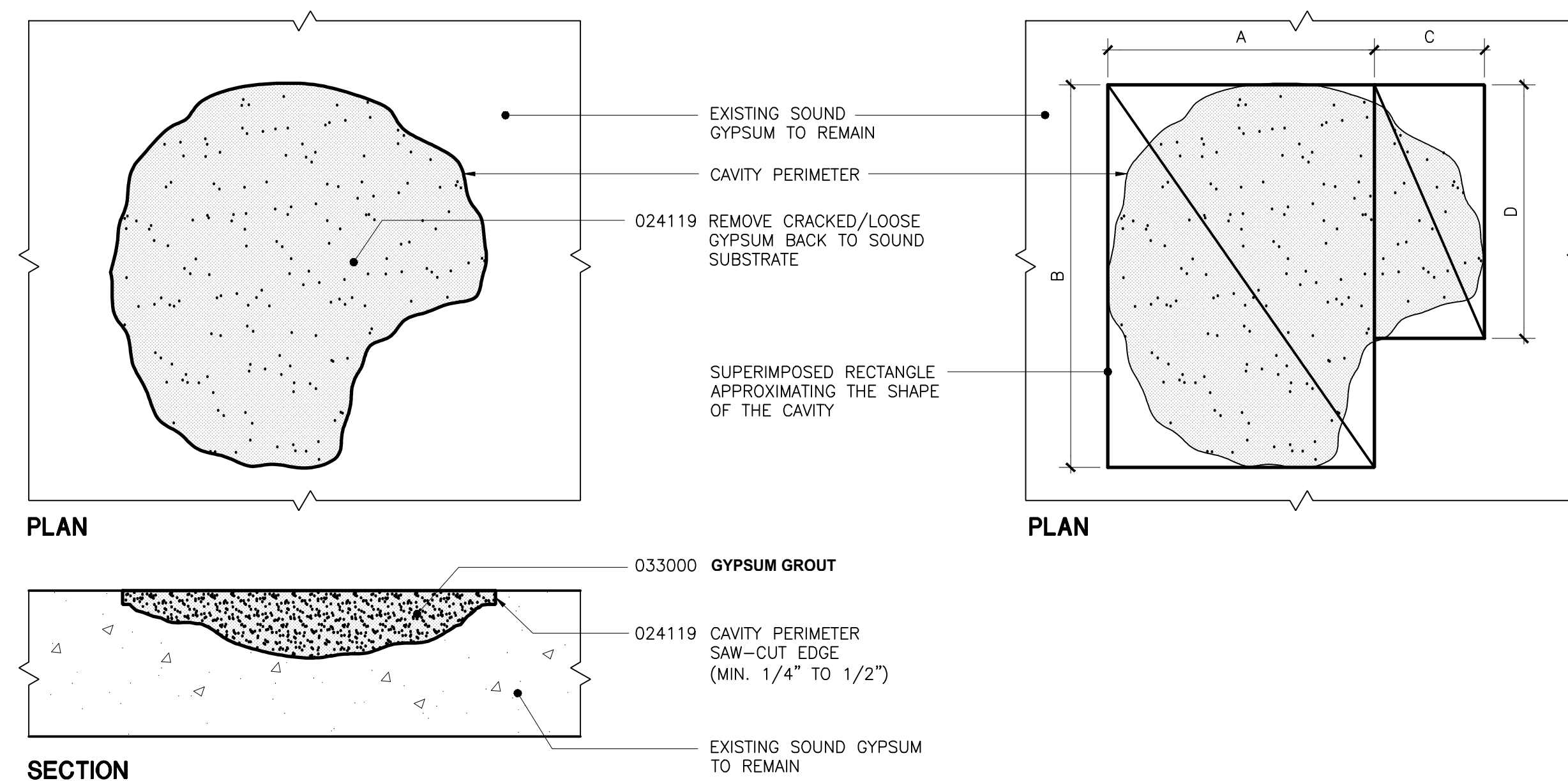

### REPAIR OF DETERIORATED GYPSUM

- AFTER REMOVING ROOFING SYSTEM, VISUALLY SURVEY GYPSUM.
- SOUND SURFACES WITH 3LB. DEAD BLOW HAMMER TO IDENTIFY EXTENT OF DETERIORATED/DELAMINATED GYPSUM TO BE REMOVED.
- MARK AREA OF DETERIORATED/DELAMINATED GYPSUM.
- CREATE A CAVITY BY REMOVING ALL LOOSE MATERIAL. (TAKE PHOTO & DOCUMENT LOCATION OF DETERIORATED AREAS BEFORE REPAIRING).
- DETERMINE QUANTITY OF GYPSUM REPAIR IN ACCORDANCE WITH QUANTIFICATION PROCEDURE DIAGRAM.
- PREPARE CAVITY SURFACE AND APPLY PATCHING GROUT AS RECOMMENDED BY MANUFACTURER'S INSTRUCTIONS.

### QUANTIFICATION PROCEDURE

- AT EACH CAVITY LOCATION, THE QUANTITY OF GYPSUM REPAIR EQUALS THE SUM OF THE AREAS OF THE SUPERIMPOSED RECTANGLES THAT APPROXIMATE THE SHAPE OF THE CAVITY.
- THE UNIT OF MEASURE FOR THE QUANTIFICATION OF GYPSUM REPAIR IS THE SQUARE FEET (SQ FT).
- THE QUANTITY OF GYPSUM REPAIR IN SQUARE FEET IS EQUAL TO:  $(A \times B) + (C \times D)$

# PCH 01

## GYPSUM DECK REPAIR/FILL (SF)

SCALE: 3" = 1'-0"

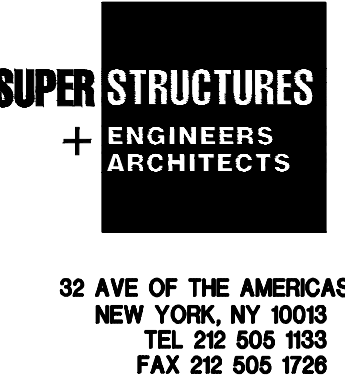

### Project Key

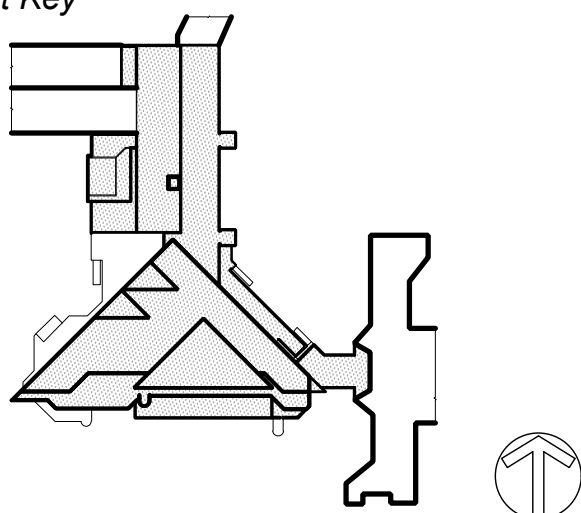

### Phase

### Revisions

Number	Description	Date

### Project Title

## ROOF REPLACEMENT BUILDINGS "U" AND "P"

Drawn By: \_\_\_\_\_ Checked By: \_\_\_\_\_ Date: \_\_\_\_\_ DASHNY Project No: \_\_\_\_\_

### Sheet Title

## DECK REPAIR DETAILS

Sheet Number

Page 18 of 50

# A-501.00